



# INSTALLATION INSTRUCTIONS

## Boulevard Windshield 27D-F83J0-V0 (Chrome) 27D-F83J0-N0 (Midnight) Stryker



### ⚠ WARNING

Please read and understand these instructions completely before installation to avoid possible injury to yourself or damage to the accessory or vehicle.

### CAUTION:

This installation should be performed by an authorized Star dealer or a qualified mechanic. Some components require information from the Model's Service Manual for proper installation or adjustment. Be sure to have the Service Manual on hand, if necessary, before proceeding with the installation.

### DEALER:

These instructions contain important information for future reference and *must* be given to the customer.

### WARRANTY INFORMATION:

- Genuine Star Accessories are covered by a one year warranty against defects in material or workmanship. Labor for replacement of defective components is not covered. See your Yamaha dealer for a copy of the warranty statement.
- The Limited Warranty provided with new Star vehicles has exclusions for certain failures, including those caused by competition or racing use as well as by abnormal strain or abuse. While installation of these components will not "void" your vehicle's warranty, specific failures adjudged by Yamaha to have resulted from the installation of accessory components or other modifications, or from competition use, may not be covered by warranty or Yamaha Extended Service for Star motorcycles.

### PARTS LIST:

This kit contains the following components. Before beginning installation, confirm there are no missing or damaged components.

Item	Part Number	Description	Qty
--	27D-F83J0-V0/N0	Boulevard Windshield Kit	--
①	*	Windscreen	1
②	*	Left Bracket	1
③	*	Right Bracket	1
④	*	Left Plate	1
⑤	*	Right Plate	1
⑥	*	Foam Damper (Inner)	2
⑦	*	Foam Damper (Outer)	2
⑧	*	Button Head Bolt (M6 X 1.0p X 20mm LG)	4
⑨	*	Domed Nut (M6)	4
⑩	*	Spacer	2
⑪	*	Button Head Bolt (M10 X 1.25p X 25mm LG)	2

\*Part supplied with kit only and not available separately.

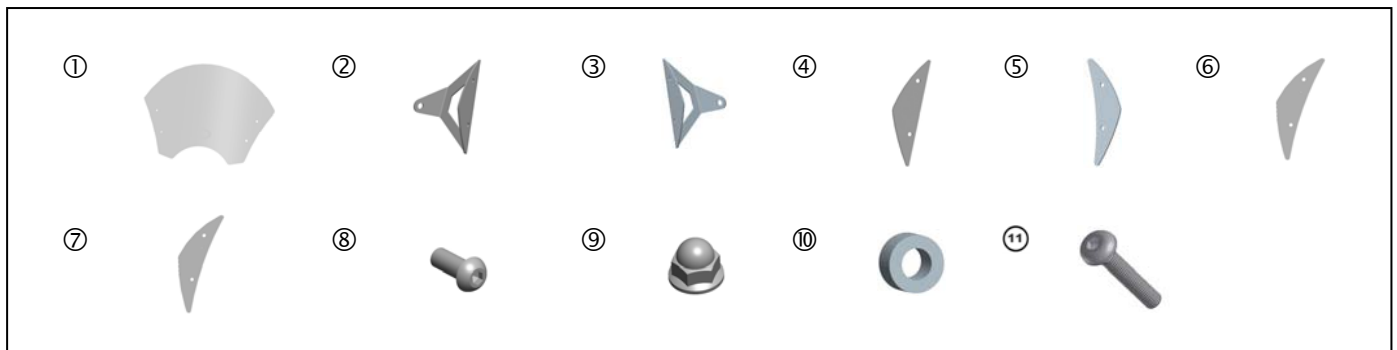
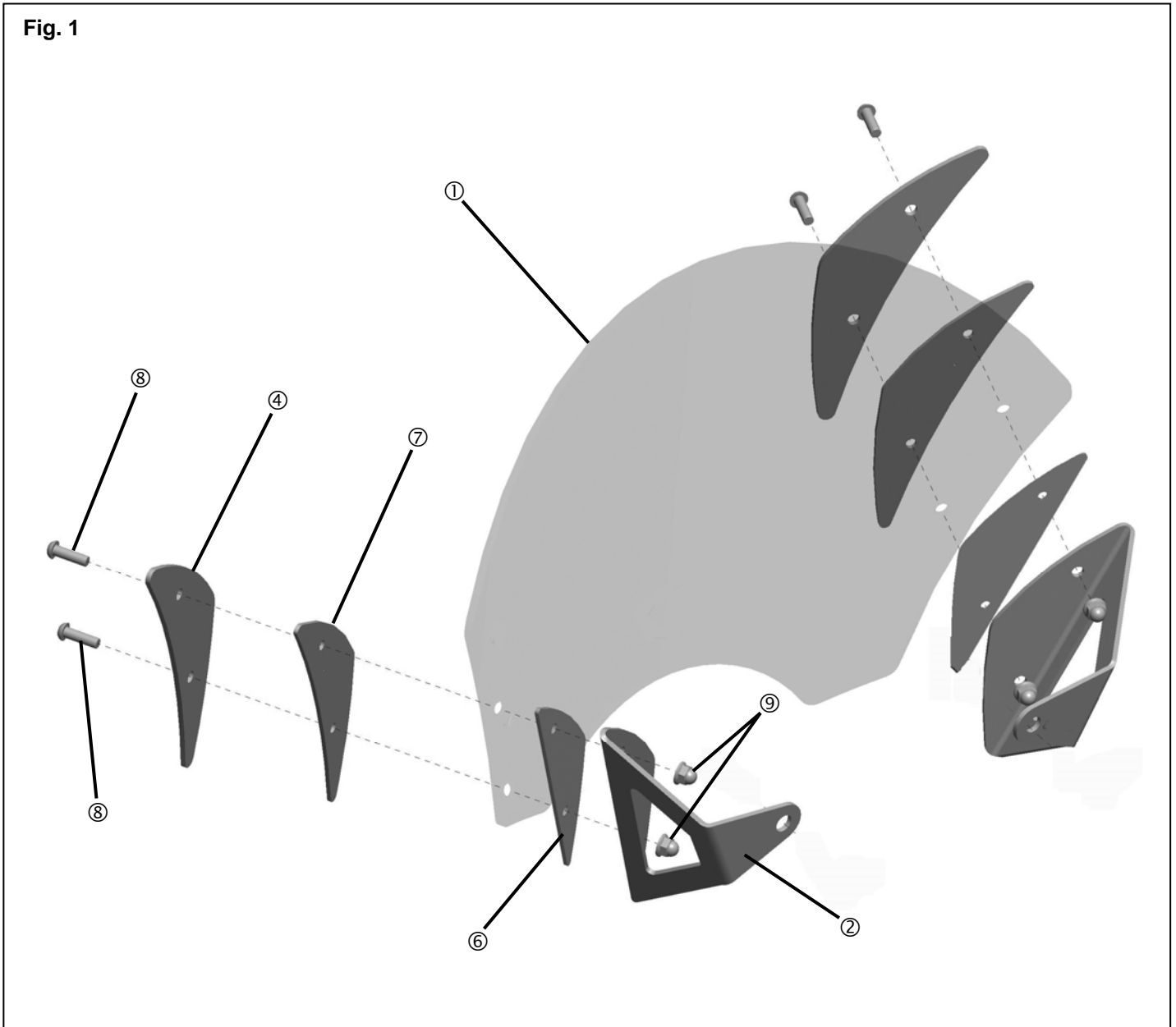

Fig. 1



**PREPARATION:**

1. Place motorcycle on a secure and level surface.
2. Clean all mounting surfaces before beginning installation.
3. Assemble the Boulevard Windshield as shown in Figure 1.
4. Torque the button head bolts ⑧ to 4 Nm (2.9 ft • lb).

**NOTE:** \_\_\_\_\_  
**Do not apply thread-locker to any of the bolts used in the assembly of the windshield.**  
\_\_\_\_\_

Fig. 2

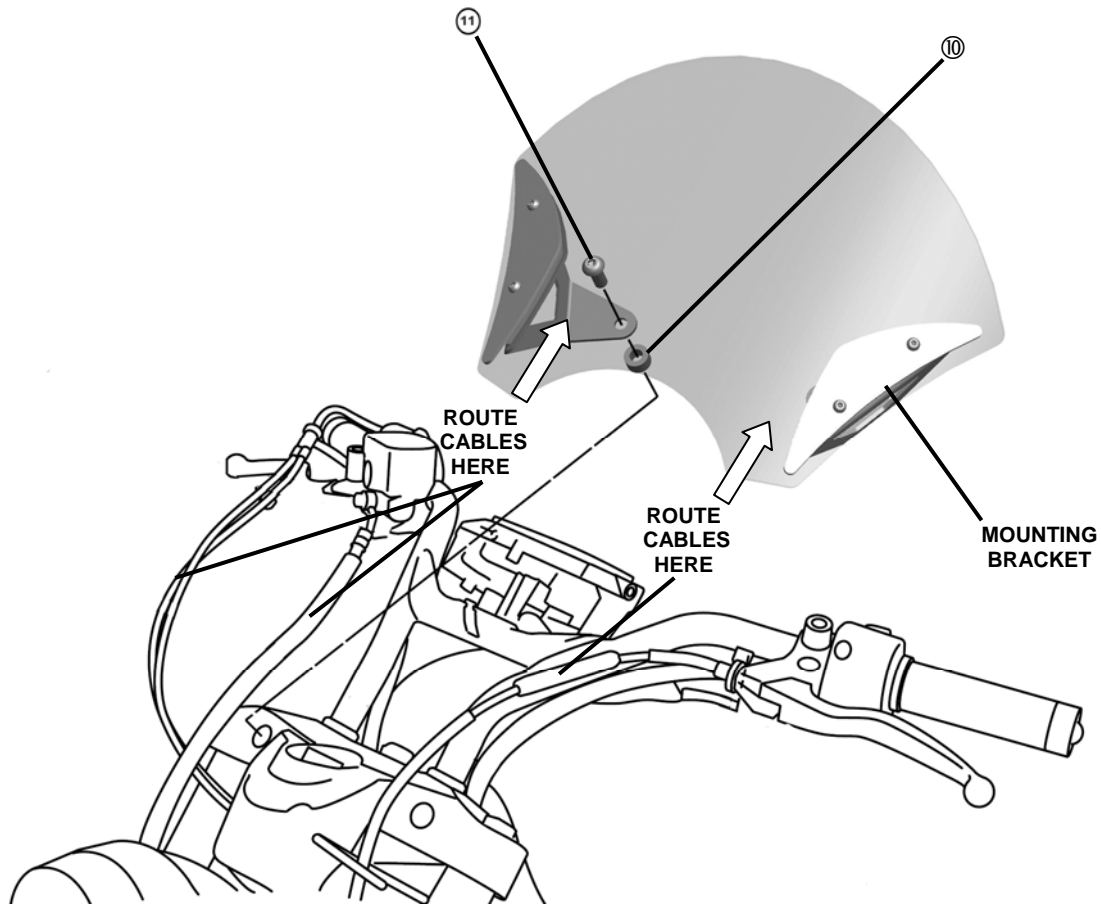

**INSTALLATION:**

**NOTE:** \_\_\_\_\_



Apply Loctite® 242 to the bolts ⑪.  
Part # ACC-24221-TL-00

1. Install the Boulevard Windshield assembly using the spacers ⑩ and bolts ⑪ as shown in Figure 2.

**NOTE:** \_\_\_\_\_

**Make sure all handlebar cables are routed in between the boulevard windshield mounting brackets (Fig. 1).**

2. Torque button head bolts to 48 Nm (35 ft • lb)

**MAINTENANCE:**

Periodically, check all hardware for tightness and re-torque as required.

**CARE AND CLEANING:**

Clean windscreen with Yamaha Windscreen Cleaner (P/N # ACC-WNDSC-CL-NR).

**CUSTOMER SERVICE:**

For further information, see your Yamaha dealer.

**ESTIMATED TIME TO INSTALL: 0.2 HRS**