



# INSTALLATION INSTRUCTIONS

## BOULEVARD KIT STR-5KS05-00-30 V-STAR (all)



### INTRODUCTION

Please read and understand these instructions completely before installation to avoid injury to your self or damage to the motorcycle or accessory.

DEALER: These instructions contain important information for future reference and must be given to the customer.

### PARTS LIST

Item	Part Name	Part Number	Description	Qty
①	Boulevard Windshield		Solar Bronze	1
②	Mounting Bracket		(Chrome)	1
③	Plate, 1		(Chrome)	2
④	Damper, 1		(Rubber)	2
⑤	Damper, 2		(Rubber)	2
⑥	Screw, Special	4NL-F8355-00-00	M6 x1.0p x18mm Stainless Steel	4
⑦	Capnut, Special	4NL-F8362-00-00	M6 x1.0p Stainless Steel	4
⑧	Washer		M6 Stainless Steel	4

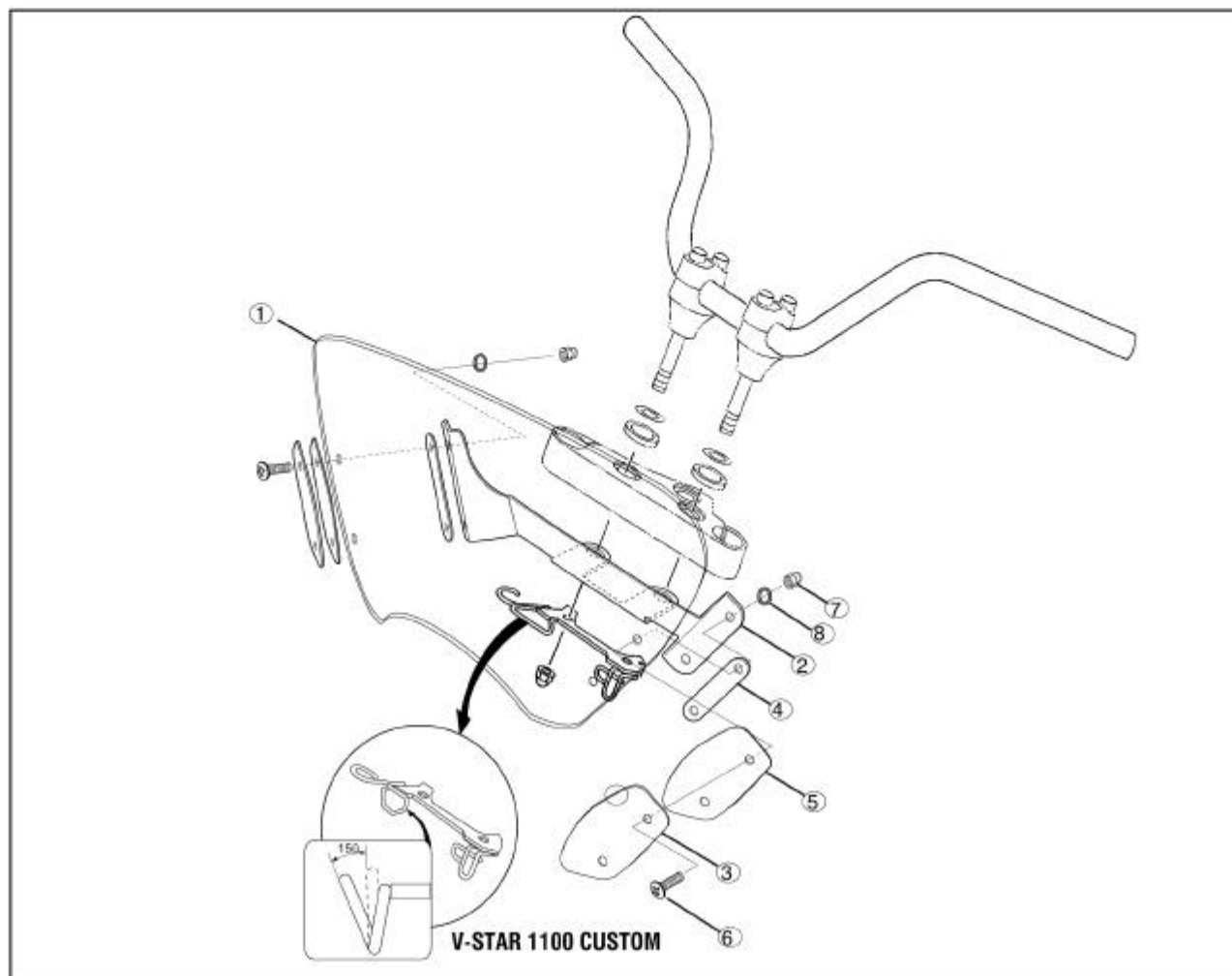

## **PREPARATION**

Place motorcycle securely on its Side Stand.

**NOTE:** For V-Star 1100 CUSTOM only- Carefully bend the Cable Guide LOOP for the Throttle Cables forward approximately 15 degrees.

## **INSTALLATION**

Study and refer to the illustration provided.

- a) Remove the Cap Nuts securing the Handlebar/Handlebar Clamps assembly.
- b) Remove the Cables Guide from the Handlebar Clamp Studs.
- c) Put the Blvd Windshield MOUNTING BRACKET, item 2 between the Cables and the Fork Crown with the Handlebar Clamps Studs through the mounting holes in the Windshield MOUNTING BRACKET.
- d) Replace the Cables Guide on the Handlebar Clamps Studs.

- e) Reinstall the Cap Nuts on the Handlebar Clamps Studs and torque them to **4.0 m-kg (29 ft-lbs)**.
- f) Following the illustration, finish assembly of the WINDSHIELD ①, PLATE 1 ③, DAMPER 1 ④, and DAMPER 2 ⑤, using the SPECIAL SCREWS ⑥, and SPECIAL CAP NUTS ⑦. Tighten the Screws and Nuts securely.

## **MAINTENANCE**

Periodically check all fasteners for tightness and retorquing as required.

## **CARE AND CLEANING**

See your Owners Manual.

## **CUSTOMER SERVICE**

For further information see your Yamaha dealer.