

INSTALLATION INSTRUCTIONS

DESCRIPTION: Headlight Brush Guard Kit
PART NUMBER: 2PG-F84L0-T0
MODEL: Viking, Viking VI



⚠ WARNING

Please read and understand these instructions completely before installation to avoid possible injury, or damage to the accessory or vehicle.

NOTICES:

This installation requires a torque wrench and should be performed by an authorized Yamaha dealer or other qualified technician.

WARRANTY INFORMATION:

Genuine Yamaha Accessories are covered by a one-year limited warranty against defects in material or workmanship. Labor for replacement of defective components is not covered. See your Yamaha dealer for a copy of the warranty statement.

DEALER OR INSTALLER:

These instructions contain important information for future reference and *must* be given to the customer.

REQUIRED PARTS NOT IN THIS KIT

This accessory requires;

- Heavy Duty Brush Guard p/n 2PG-F84L0-V0.
See your Yamaha dealer for more information.

PARTS LIST:

No.	Part Number	Description	Qty
--	2PG-F84L0-T0	Headlight Brush Guard Kit	--
①	*	Right Side Headlight Guard	1
②	*	Left Side Headlight Guard	1
③	*	M8 Button-Head Hex Bolt M8 x 1.25 x 20 mm	4
④	*	Nylock Nut	4
⑤	*	Washer	4

* Part supplied with kit only and not available separately.

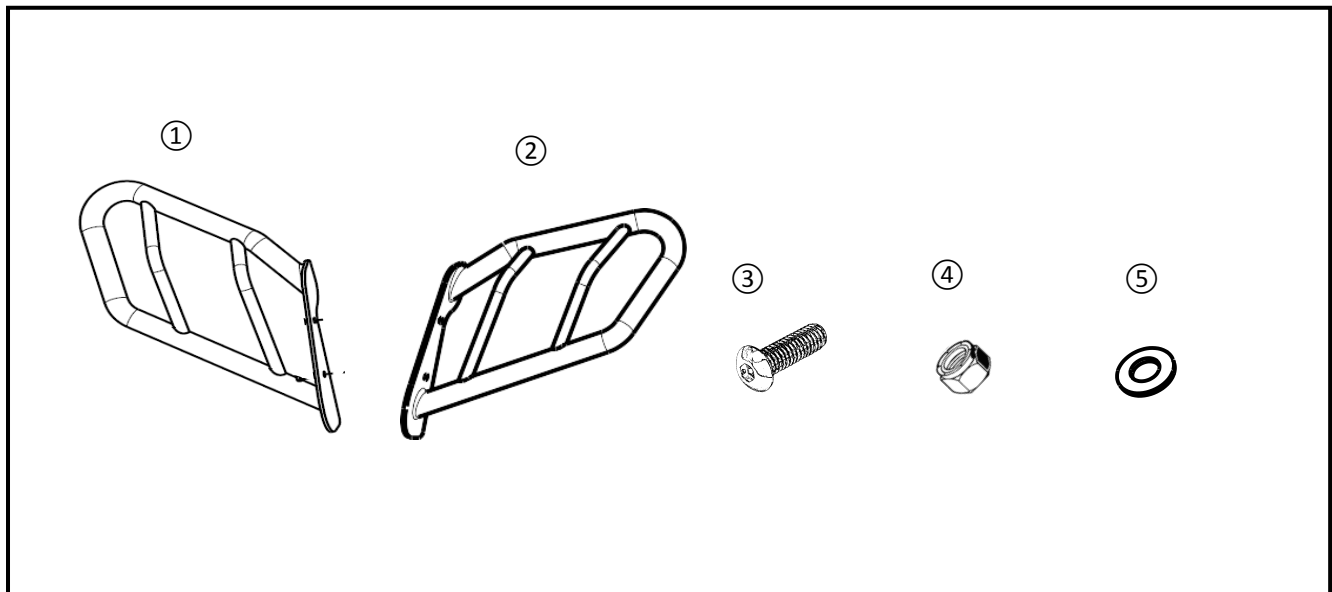

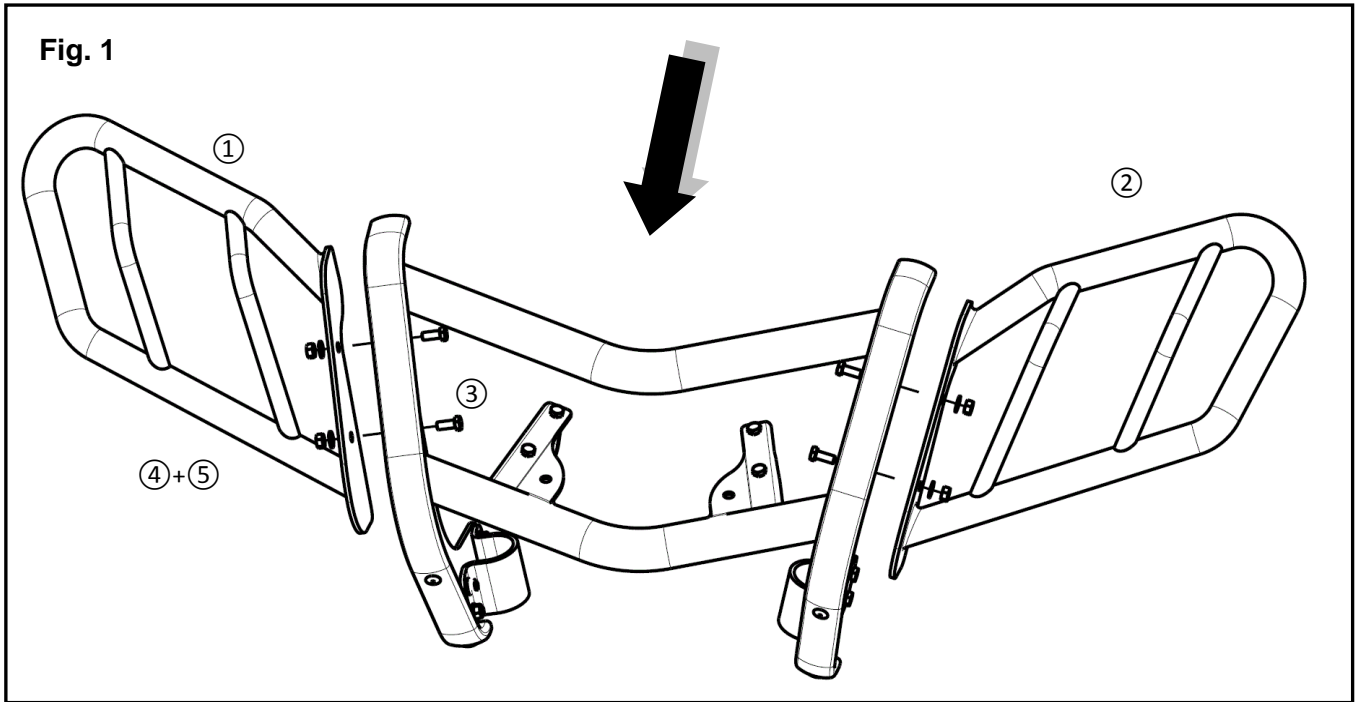

PREPARATION:

- Place the vehicle on a secure and level surface.
- Set the parking brake.
- Clean the mount surfaces before starting installation.

INSTALLATION:

1. Locate the Right Side Headlight Guard ① and fit it to the Heavy Duty Brush Guard (p/n 2PG-F84L0-V0) as shown in (Fig. 1) using the M8 Button-Head Hex Bolts ③, Washers ⑤, and Nylock Nuts ④.
2. Repeat the step above for the Left Side Headlight Guard ② and torque all Nylock Nuts ④ to 25 Nm (2.5 m - kg, 18 ft - lb).

MAINTENANCE:

Periodically, check torque on all hardware. If loose hardware is found, re-torque to specification.

CARE AND CLEANING:

Clean painted metal parts with a clean soft cloth and mild soap and water. Rinse and dry. Clean the windscreen with a clean soft cloth and mild soap and water solution.

CUSTOMER SERVICE:

For further information see your Yamaha dealer.

ESTIMATED TIME TO INSTALL: 0.3 HRS