

TRUNK RACK
INSTALLATION INSTRUCTIONS
STR-4XY62-50-00
"VENTURE"



INTRODUCTION

Please read and understand these instructions completely before installation to avoid any possible injury to yourself or damage to your motorcycle and/or accessory.

DEALER: These instructions contain important information for future reference and must be given to the customer.

CAUTION: Maximum load is 10 lb (4.5 kg).

PARTS LIST			
Item	Part Name	Description	Qty
①	Trunk Rack		1
②	Lid Reinforcement 1	Chrome Plated	2
③	Lid Reinforcement 2	Zinc Plated	2
④	Rubber Damper	15.9mm OD x 6.5mm ID x 1.6mm thick	4
⑤	Bolt, Flange Head	M6 x 1.0p x 16mm long	4
⑥	Collar	8mm OD x 6.2mm ID x 9.8mm long	4

TOOLS & MATERIALS REQUIRED

- 11/32" Drill Bit and Electric Drill
- 10mm Combination Wrench
- Masking Tape

INSTALLATION

1. Place the motorcycle securely on the side stand.
2. Remove the contents of the trunk. Clean the top of the trunk thoroughly.
3. Use masking tape to cover the top of the trunk where the rack will be located.
4. Carefully set the Trunk Rack ① in position on the trunk. Center the rack from side to side, with approximately 1 to 1-1/2 inches (25 to 38mm) clearance between the front rail of the rack and the back of the backrest cushion.
5. While holding the rack firmly in position, use a marking pen to trace around each of the four mounting feet on the masking tape. Remove the rack.

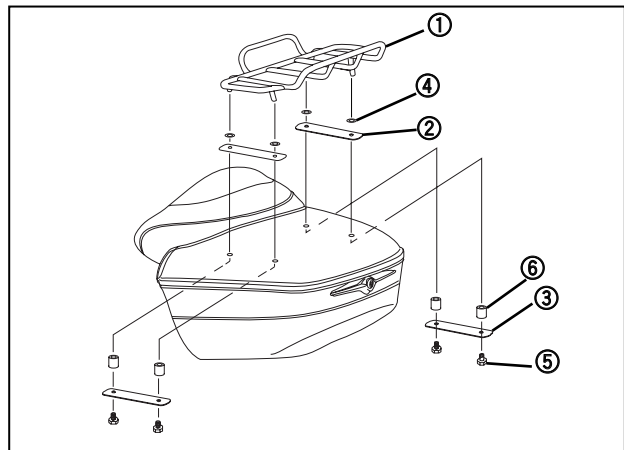

6. Locate the center of each circle drawn on the masking tape. Using a 11/32" bit, drill only the front hole on both sides down through the top of the trunk.
7. Confirm proper hole position by inserting the Bolts ⑤ through the Collars ⑥ from inside the trunk, then temporarily installing them into the front mounting holes in the Rack 1. Also confirm that the circles you draw for the rear mounting feet are still correctly positioned. Remove the rack again.

NOTE: If the front holes are not correctly lined up, carefully use a fine rat-tail file to enlarge the hole in the trunk slightly.

8. Confirm proper alignment of the two rear holes before drilling. Put the upper Lid Reinforcement ② plates on the trunk so that the slotted-hole ends are to the rear. Put a Bolt ⑤ in each front hole to hold the Reinforcements ② in place, then check that the marks you made for drilling can be seen in the slotted holes (moving the Reinforcement plates to one side or the other if needed). If proper alignment is confirmed, remove the Lid Reinforcements and Bolts and drill the two back holes.

NOTE: If alignment is not correct, install the rack again as in Step 7, then re-mark the drilling hole for rear mounting feet locations as in Steps 5 and 6 before drilling the holes.

9. After all four holes are drilled, chamfer the sharp edges of the drilled holes with a fine file then carefully remove the masking tape. Use isopropyl alcohol if necessary to remove any remaining adhesive.

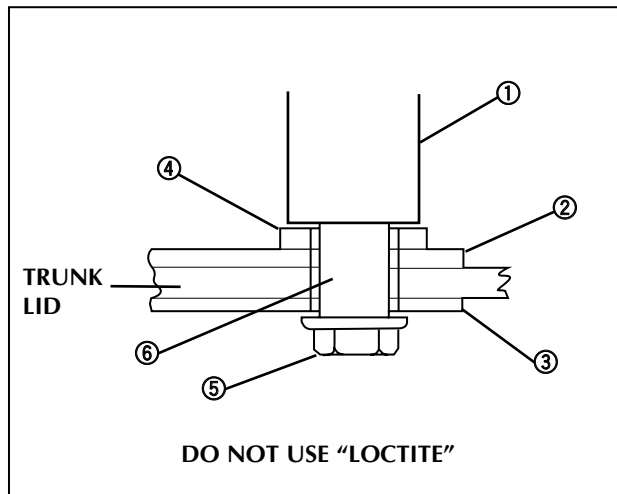

10. Position the lower Lid Reinforcements ③ on the under side of the trunk lid with the slotted-hole end to the rear, then insert the Bolts ⑤ through the Collars ⑥ and up through the holes. Put the upper Lid Reinforcements ② on the Bolts with the slotted-hole end to the rear. Put a Rubber Damper ④ on each bolt, then install the Trunk Rack ①.

NOTE: The Collars ⑥ must go through the Lower and Upper Lid Reinforcements and the Rubber Dampers.

11. Carefully tighten the mounting Bolts ⑤ securely.

NOTE: DO NOT use "Loctite"

MAINTENANCE

Periodically check bolts for tightness.

CARE AND CLEANING

Refer to your Owner's Manual.

CUSTOMER SERVICE

See your Yamaha Dealer.