

**REAR RACK**  
**INSTALLATION INSTRUCTIONS**  
**STR-4TR51-10-00**  
**V STAR "CUSTOM"**



**INTRODUCTION**

Please read and understand these instructions completely before installation to avoid any possible injury to yourself or damage to your motorcycle and/or accessory.

**DEALER:** These instructions contain important information for future reference and must be given to the customer.

PARTS LIST			
Item	Part Name	Description	Qty
①	Rear Rack	STR-4TR51-10-00	1
②	Cushion, Rubber w/Adhesive Backing	19mm O.D. x 2.4mm Thick	2
③	Washer, Rubber	6.4mm I.D. x 12.7mm O.D.	2
④	Screw, Hex Head Flange	M6 x 1.0P x 10 Long	2
⑤	Washer, Plain	6mm x 14mm O.D.	2

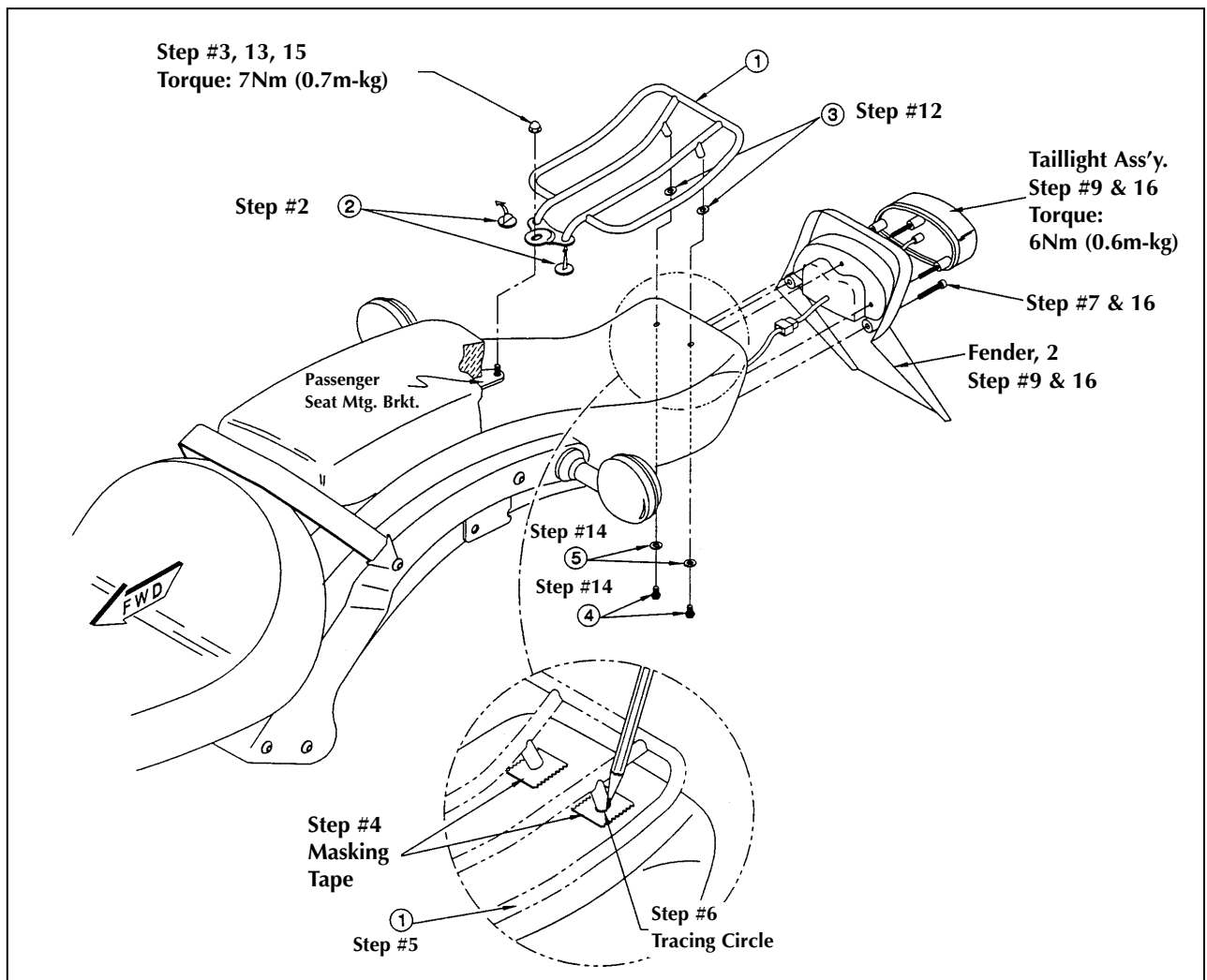

## **INSTALLATION**

---

1. Place the motorcycle on level ground and securely on the side stand.
2. Find two each **Rubber Cushions** ② in Hardware Kit. Clean the bottom surface of the **Rear Racks "Front Mounting Bracket"** ①. Peel off the protective paper on the Rubber Cushions and install as shown.
3. Remove the fastener securing the Passenger Seat to the Fender.
4. Approximate and apply masking tape to the areas on the fender where the Rear Racks mounting feet will rest when positioned in place.
5. Temporarily place the Rear Rack in position on the fender being assured that the racks mounting feet rest on the area's covered by the masking and that it is properly aligned on the fender.
6. Using a suitable marking pen, trace a circle on the masking tape around the perimeter of each rear mounting foot as shown. Put the Rear Rack aside and mark the center of each circle.
7. From the rear of the bike, just under the Taillight, remove the two Screws holding the Fender 2 in place.
8. From the underside of the rear Fender, remove the three Hex Nuts and Washers holding the Taillight Assembly in place.
9. At this point both the Fender 2, and the Taillight Assembly should be free of the bike and can gently hang from its wiring temporarily.
10. Using a .062 diameter drill bit, drill a pilot hole in the center of each circle traced in Step 6.
11. Open up the two pilot holes by drilling them through with a 1/4" (.25 dia.) drill bit. **DO NOT ALLOW THE DRILL BIT TO BREAK THROUGH ABRUPTLY!** Carefully remove the masking tape and clean the fenders surface.
12. Place a **Rubber Washer** ③, over each of these two mounting holes and set the Rear Rack in place on the Fender.
13. Using the same fastener removed in Step 3, install the Rear Racks Front Bracket and the Passenger Seat Rear Bracket to the fender, as illustrated. Finger tighten only.
14. From the Fenders underside install the supplied **Screws and Washers** ④ & ⑤ to the Mounting Feet of the Rear Rack. Tighten screws securely, alternating between the two.
15. Tighten the fastener removed in Step 3 to the specification given on the illustration.
16. Reinstall the Fender 2, and the Taillight Assembly using the same fasteners removed in Steps 7 and 8.

### **CAUTION:**

**Maximum load limit on rear rack is 6 lbs.**

## **MAINTENANCE**

---

Periodically check mounting hardware for looseness and re-torque as required.

## **CARE AND CLEANING**

---

Refer to your Owner's Manual.

## **CUSTOMER SERVICE**

---

For more information regarding installation please contact your Yamaha dealer.