



**INSTALLATION INSTRUCTIONS
KICK SHAFT KIT
GYT-5TG07-20-00
5TG (YFZ450)**



Note: Battery removal capacitor Kit P/N GYT-5TG97-50-00 must also be installed with this kit if battery is removed on all YFZ450.

⚠WARNING

Please read and understand these instructions completely before installation to avoid possible injury to yourself, or damage to the accessory or vehicle.

CAUTION:

- This installation should be performed by an authorized Yamaha dealer or a qualified mechanic. Some components require information from the model's service manual for proper installation or adjustment. Be sure to have the service manual on hand, if necessary, before proceeding with the installation.
- Alteration of emission-related components constitutes tampering under Federal and State laws and can lead to substantial fines and penalties if used other than in closed-course competition.
- GYTR engine-related competition parts are intended for closed-course racing applications only.

Dealer:

These instructions contain important information for future reference and *must* be given to the customer.

Warranty Information:

- Genuine Yamaha GYTR components are covered by a 90-day warranty against defects in material or workmanship. Labor for replacement of defective components is not covered. See your Yamaha dealer for a copy of the warranty statement.
- The Yamaha Limited Warranty provided with new Yamaha vehicles has exclusions for certain failures, including those caused by competition or racing use (except YZ and WR motorcycle models) as well as by abnormal strain or abuse. While installation of these GYTR components will not "void" your vehicle's warranty, specific failures adjudged by Yamaha to have resulted from the installation of accessory components or other modifications, or from competition use (except YZ and WR motorcycle models), may not be covered by warranty or Yamaha Extended Service.

1. Kit Contents:

This kit contains the following components, before beginning installation confirm there are no damaged or missing items.

Item #	Part Number	Part Name and Description	Qty
1	5XD-15601-00-00	KICK SHAFT ASSEMBLY	1
2	90201-162H4-00	WASHER	1
3	5SG-15668-00-00	STOPPER	1
4	214-15686-00-00	LOCK WASHER	1
5	90101-06001-00	BOLT	2
6	93102-20108-00	OIL SEAL	1
7	5TA-15651-00-00	KICK IDLE GEAR	1
8	90201-20276-00	WASHER	1
9	99009-20400-00	CIRCLIP	1

2. Removal / Installation:

NOTE: It is recommended that this installation be performed by an authorized Yamaha dealer, and will REQUIRE the use of a YFZ450s service manual (LIT-11616-17-11).

- a) Remove the right crank case cover. See section 5 (water pump) in the service manual.
- b) Remove the plug from the crank case cover. Install the oil seal item # 6 from the outside of the case.
(Note: the oil seal number should be facing towards the outside of the case).
- c) Remove the clutch basket. See section 4-48 in the service manual.
- d) Install the remaining kick shaft components as per the following illustrations. (Note: the stopper plate (item # 3) needs to be installed with the two supplied bolts (item # 5) before the kick shaft assembly (item # 1) is installed. Torque the two bolts to 10 Nm (7.2 ft. lbs.) See illustration on pg 4 (Reference 3) for location.
- e) Install the right crank case cover. See section 5 (water pump) in the service manual.
- f) Install the clutch assembly. See section 4-48 in the service manual.

KICK AXLE AND SHIFT SHAFT

ENG



KICK AXLE AND SHIFT SHAFT

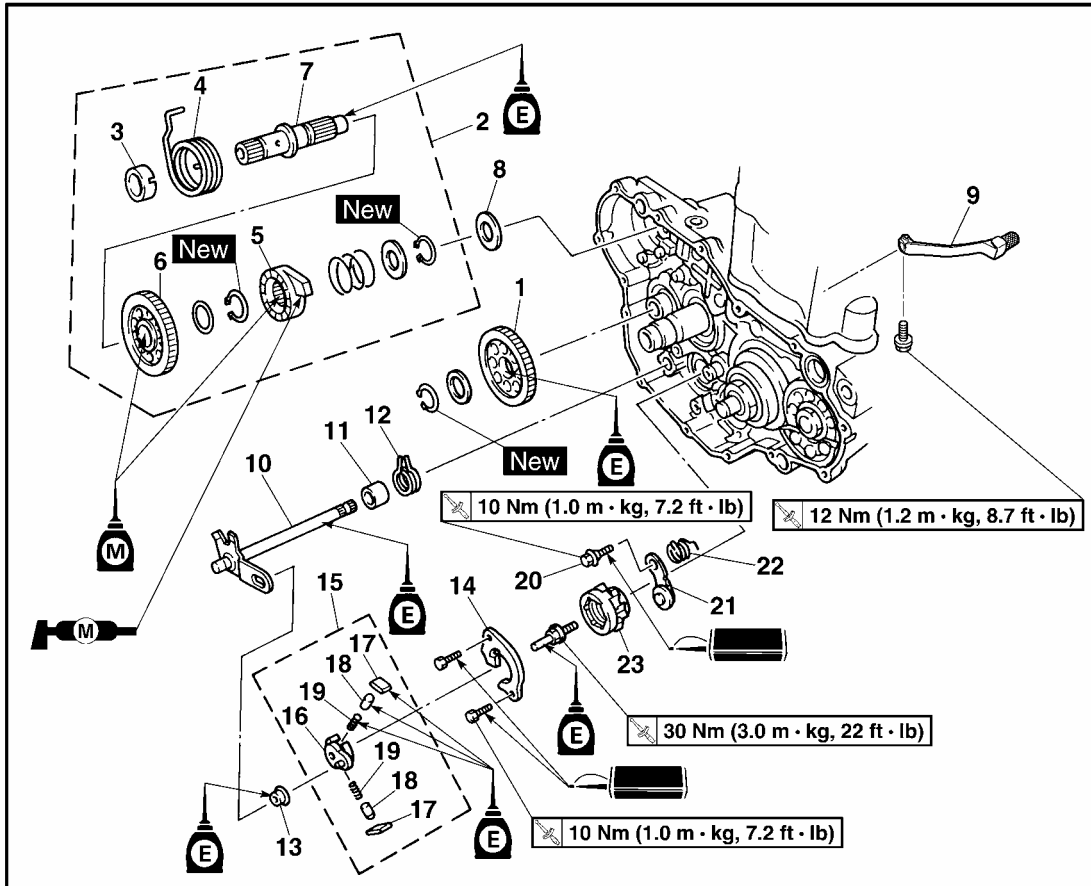

Extent of removal:

- ① Kick axle removal
- ② Kick axle disassembly
- ③ Shift shaft removal
- ④ Segment removal

Extent of removal	Order	Part name	Q'ty	Remarks
KICK AXLE AND SHIFT SHAFT REMOVAL				
Preparation for removal		Oil pump		Refer to "OIL PUMP" section.
① ↓	1	Kick idle gear	1	Refer to "REMOVAL POINTS".
	2	Kick axle assembly	1	
	3	Spring guide	1	
	4	Torsion spring	1	
	5	Ratchet wheel	1	
	6	Kick gear	1	
	7	Kick axle	1	
	8	Plain washer	1	
	9	Shift pedal	1	
① ↓	10	Shift shaft	1	
	11	Collar	1	
	12	Torsion spring	1	

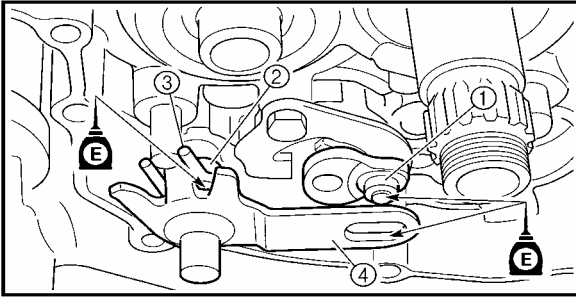

EC4C5301

Shift shaft

1. Install:
 - Roller ①
 - Collar ②
 - Torsion spring ③
 - Shift shaft ④

NOTE:

Apply the engine oil on the roller and shift shaft.

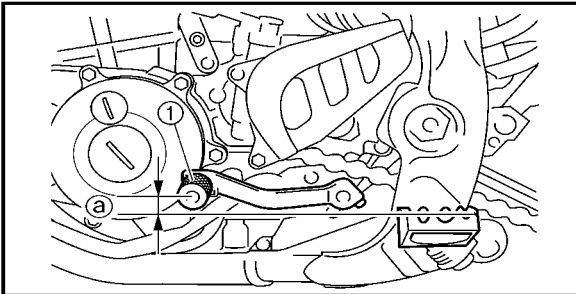

2. Install:
 - Shift pedal ①
 - Bolt (shift pedal) ②

12 Nm (1.2 m · kg, 8.7 ft · lb)

NOTE:

When installing the shift pedal onto the shift shaft, be sure that the center of the shift pedal is about 2 mm (0.08 in) ③ above the top of the footrest.

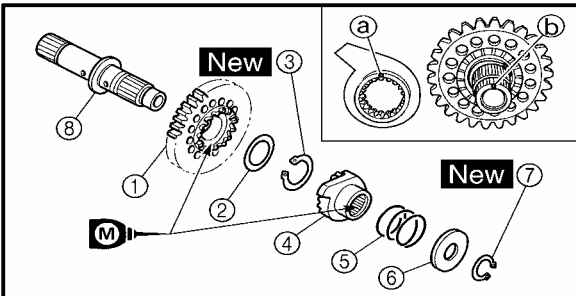

Kick axle assembly

1. Install:
 - Kick gear ①
 - Plain washer ②
 - Circlip ③ **New**
 - Ratchet wheel ④
 - Spring ⑤
 - Plain washer ⑥
 - Circlip ⑦ **New**
 To kick axle ⑧.

NOTE:

- Apply the molybdenum disulfide oil on the inner circumferences of the kick gear and ratchet wheel.
- Align the punch mark ③ on the ratchet wheel with the punch mark ④ on the kick axle.

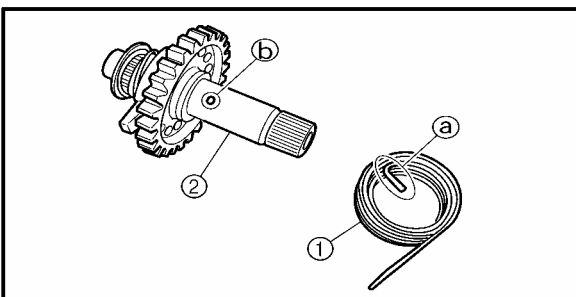

2. Install:
 - Torsion spring ①
 To kick axle ②.

NOTE:

Make sure the stopper ③ of the torsion spring fits into the hole ④ on the kick axle.

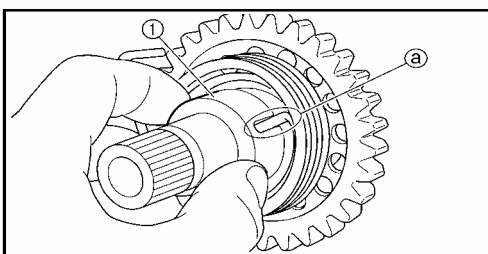

3. Install:
- Spring guide ①

NOTE: _____
Slide the spring guide into the kick axle, make sure the groove (a) in the spring guide fits on the stopper of the torsion spring.

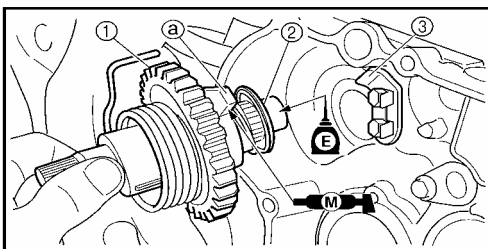

4. Install:
- Kick axle assembly ①
 - Plain washer ②

NOTE: _____
• Apply the molybdenum disulfide grease on the contacting surfaces of the kick axle stopper (a) and stopper plate ③.
• Apply the engine oil on the kick axle.
• Slide the kick axle assembly into the crankcase and make sure the kick axle stopper fits into the stopper plate.

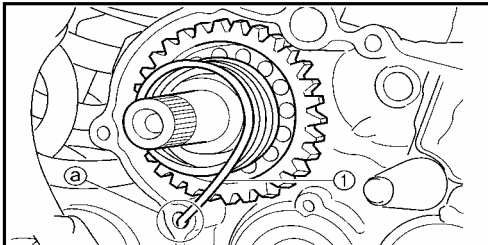

5. Hook:
- Torsion spring ①

NOTE: _____
Turn the torsion spring clockwise and hook into the proper hole (a) in the crankcase.

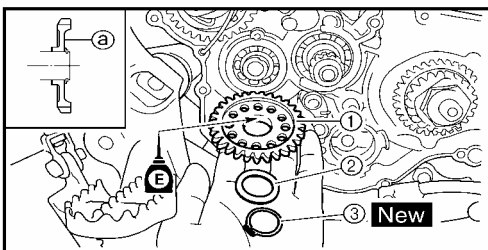

Kick idle gear

1. Install:
- Kick idle gear ①
 - Plain washer ②
 - Circlip ③ **New**

NOTE: _____
• Install the kick idle gear with its depressed side (a) toward you.
• Apply the engine oil on the kick idle gear inner circumference.

3. Maintenance:

Periodically check torque on all hardware. If loose hardware is found, remove hardware, clean off old Loctite, re-apply fresh Loctite and re-torque to specification.

4. Care and Cleaning:

Wash using a mild soap and water solution and soft cloth

5. Customer Service:

For further information see your Yamaha dealer.