

INSTALLATION INSTRUCTIONS  
HEATED GRIP KIT  
ABA-2D237-40-00  
2006-2007 FJR1300A



**WARNING**

Please read and understand these instructions completely before installation to avoid possible injury to yourself, or damage to the accessory or vehicle.

**CAUTION:**

- This installation should be performed by an authorized Yamaha dealer or a qualified mechanic. Some components require information from the model's service manual for proper installation or adjustment. Be sure to have the service manual on hand, if necessary, before proceeding with the installation.

**DEALER:**

These instructions contain important information for future reference and *must* be given to the customer.

**WARRANTY INFORMATION:**

- Genuine Yamaha GYTR components are covered by a 90-day warranty against defects in material or workmanship. Labor for replacement of defective components is not covered. See your Yamaha dealer for a copy of the warranty statement.
- The Limited Warranty provided with new Yamaha vehicles has exclusions for certain failures, including those caused by competition or racing use (except YZ and WR motorcycle models) as well as by abnormal strain or abuse. While installation of these GYTR components will not "void" your vehicle's warranty, specific failures adjudged by Yamaha to have resulted from the installation of accessory components or other modifications, or from competition use (except YZ and WR motorcycle models), may not be covered by warranty or Yamaha Extended Service.

**NOTE: THIS INSTALLATION REQUIRES A SERVICE MANUAL. BE SURE TO HAVE THE PROPER SERVICE MANUAL ON HAND BEFORE ATTEMPTING INSTALLATION!**

**1. PARTS LIST:**

This kit contains the following components. Before beginning installation confirm there are no missing or damaged components.

Item #	Part Number	Description	Qty
1	2D2-82963-00-00	Left Grip Warmer	1
2	2D2-82960-00-00	Right Grip Warmer	1
3	2D2-26281-00-00	Upper Grip Cap	1
4	2D2-26282-00-00	Lower Grip Cap	1
5	2D2-85590-00-00	Control Unit Assembly	1
6	2D2-85542-00-00	Bracket	1
7	2D2-26299-00-00	Mirror Fitting Plate 2	1
8	2D2-8272F-00-00	Guide Plate 1	1
9	5PW-2411J-01-00	Side Cover Damper	1
10	97702-30510-00	Tapping Screw	2
11	98502-03008-00	Pan Head Screw	1
12	98507-05035-00	Socket Head Screw	1
13	91317-05035-00	Bolt	2

\* Part supplied with kit only and not available separately.

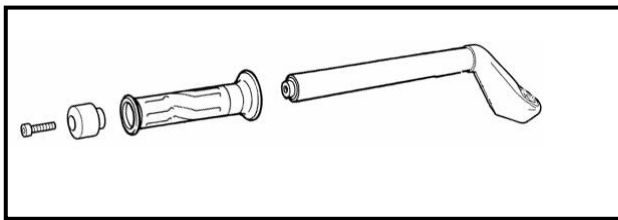
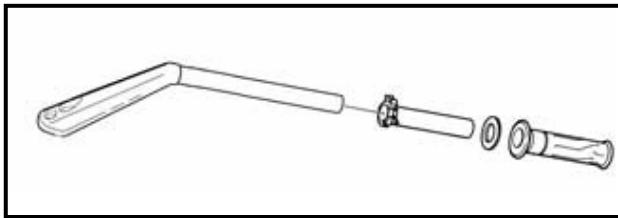
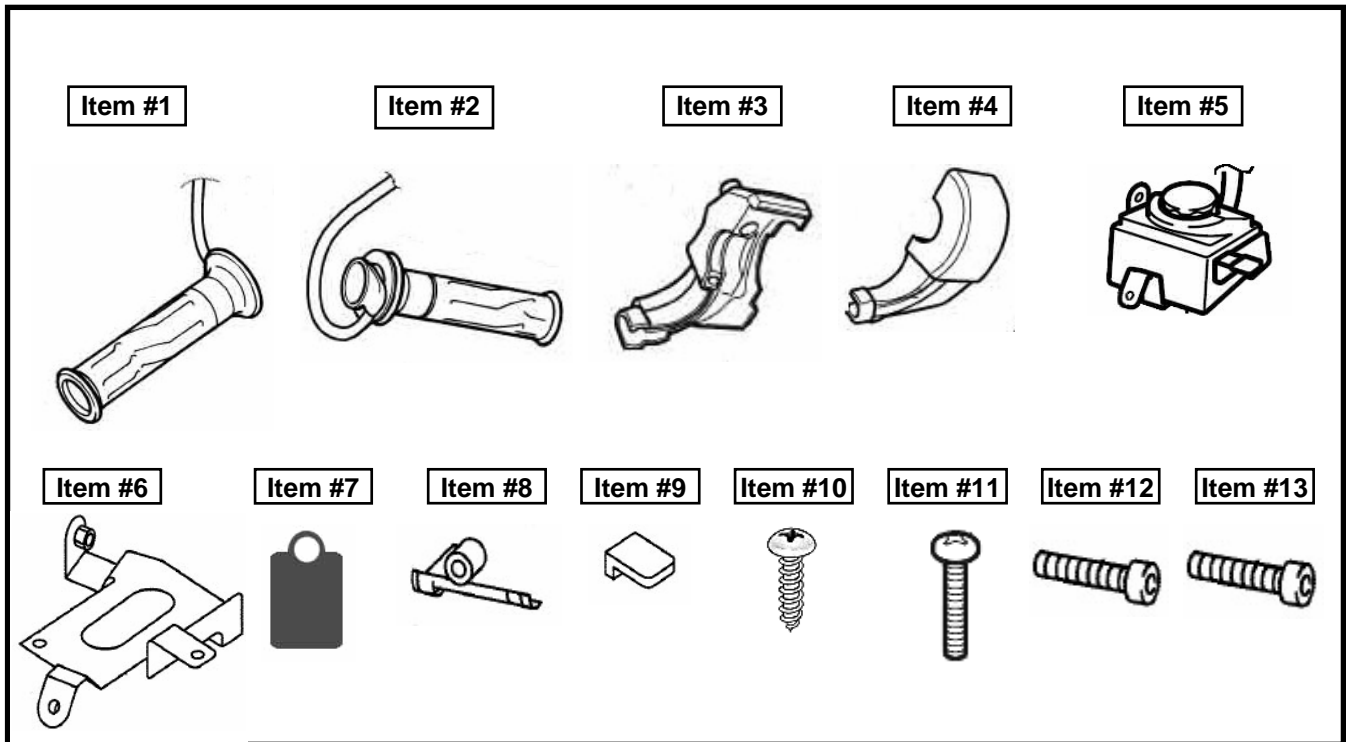

## 2. PREPARATION:

- Place motorcycle on a secure level surface.
- Clean all mounting surfaces before beginning installation.
- Remove stock bar ends and grips.
- Remove stock throttle housing.
- Remove switch housings to move to inner positions. Discard plastic spacer ring.

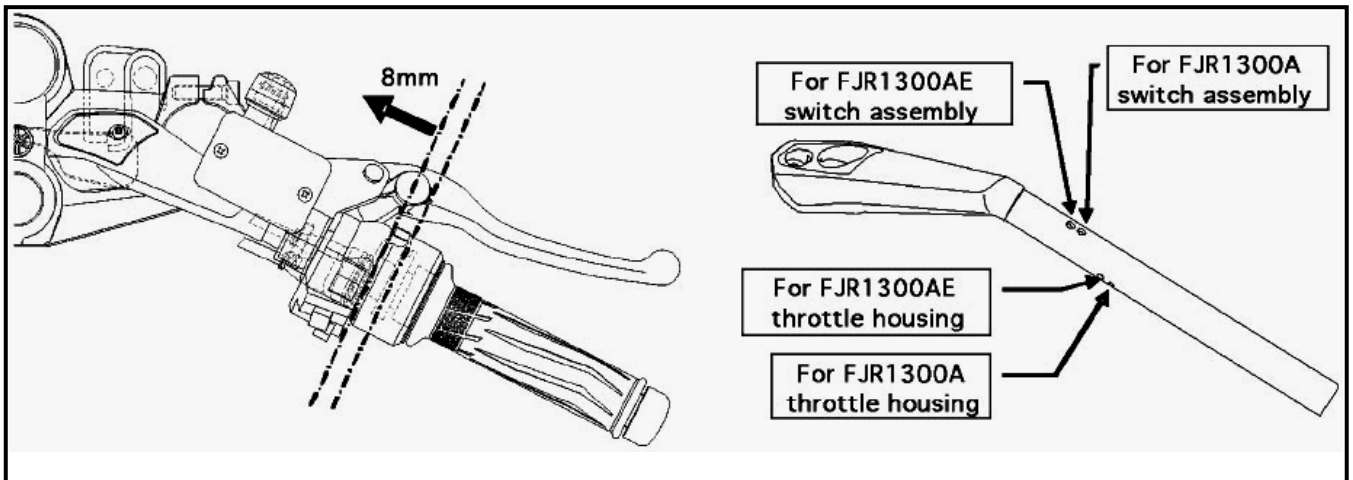

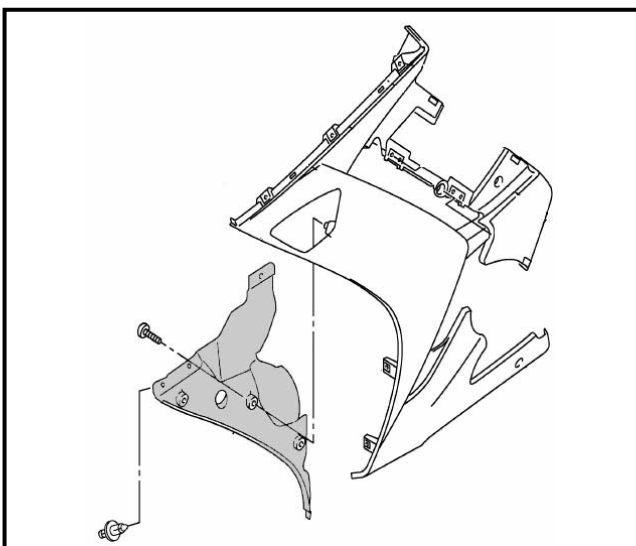
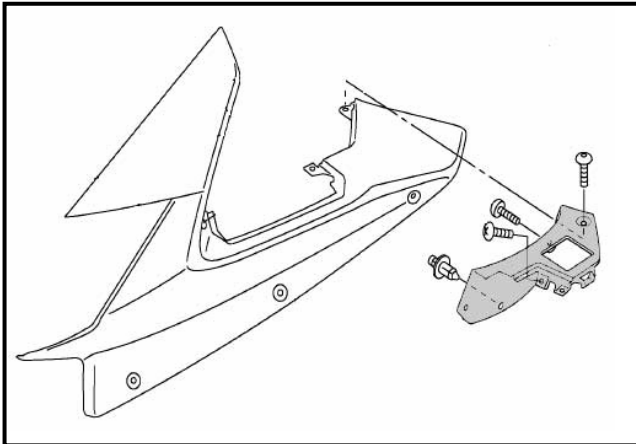
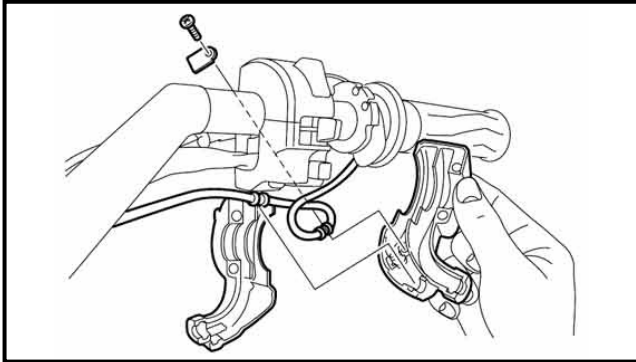
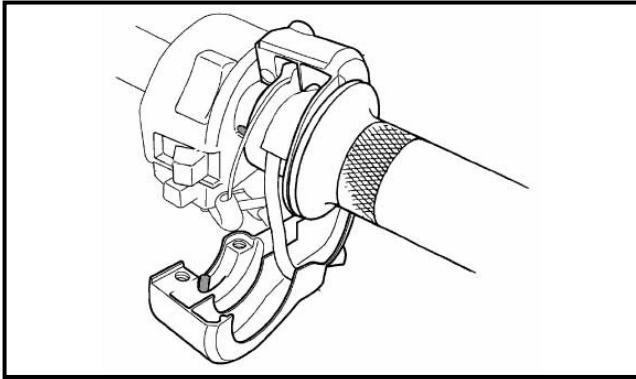

### 3. INSTALLATION:

- Refer to Service Manual Chassis section, “Handlebar” for installation details. Install grips and housings using FJR13AE section. Make sure to install fitting plate with pan head screw and the guide plate with the socket head screw as shown.
- Install new grips as and route wiring under handlebar as described in Service Manual. The handlebar may need to be loosened to access the screws holding the retaining tab under the bar.
- Remove upper panel and black inner panel on left side (near radiator).
- Remove plastic cover in panel.
- Install controller onto bracket using the two tapping screws. Slide damper onto bracket tab.
- Install bracket onto underside of panel using stock hardware.
- Locate the blue connector and white two-pin connector under the panel area. Remove the blind plug from the white connector.
- Connect the controller wires to their respective connectors.
- Locate the black single pin connector and the gray single pin connector. Plug the corresponding grip wires into these.
- Reinstall the cowling panels.

Torque handlebar bolt to 23 Nm (17 ft • lb)  
 Torque handlebar nut to 65 Nm (47 ft • lb)  
 Torque master cylinder clamps to 10 Nm (7.2 ft • lb)  
 Torque cowl screws to 10 Nm (7.2 ft • lb)

### 4. MAINTENANCE:

Periodically check all hardware for tightness and re-torque as required.

### 5. CARE AND CLEANING:

Wash using a mild soap and water solution and soft cloth.

### 6. CUSTOMER SERVICE:

For further information see your Yamaha dealer.

**ESTIMATED TIME TO INSTALL: 1.5 HRS**

### NOTE:

The heated grips only operate at 50% when vehicle speed is less than 8mph.

