

## INSTALLATION INSTRUCTIONS

DESCRIPTION: Under Seat Storage Box Kit  
 PART NUMBER: 1XD-F83P0-S0  
 MODEL: Viking



### ⚠ WARNING

Please read and understand these instructions completely before installation to avoid possible injury, or damage to the accessory or vehicle.

### WARRANTY INFORMATION:

Genuine Yamaha Accessories are covered by a one-year limited warranty against defects in material or workmanship. Labor for replacement of defective components is not covered. See your Yamaha dealer for a copy of the warranty statement.

### NOTICES:

This installation requires a torque wrench and should be performed by an authorized Yamaha dealer or other qualified technician.

### DEALER OR INSTALLER:

These instructions contain important information for future reference and *must* be given to the customer.

### PARTS LIST:

This kit contains the following components. Before beginning installation confirm there are no missing or damaged components.

Item #	Part Number	Description	Qty
--	1XD-F83P0-S0	Under Seat Storage Box	--
①	*	Storage Box	1
②	*	Large Storage Box Bracket	1
③	*	Seat Pad	2
④	*	Flange Bolt M8 x16 mm	2
⑤	*	Small Storage Box Bracket	1
⑥	*	Flange Bolt M6 x 16mm	2
⑦	*	Cap	1
⑧	*	Cap Seal	1
⑨	*	Plug	1
⑩	*	Damper Plate	1

\* Part supplied with kit only and not available separately.

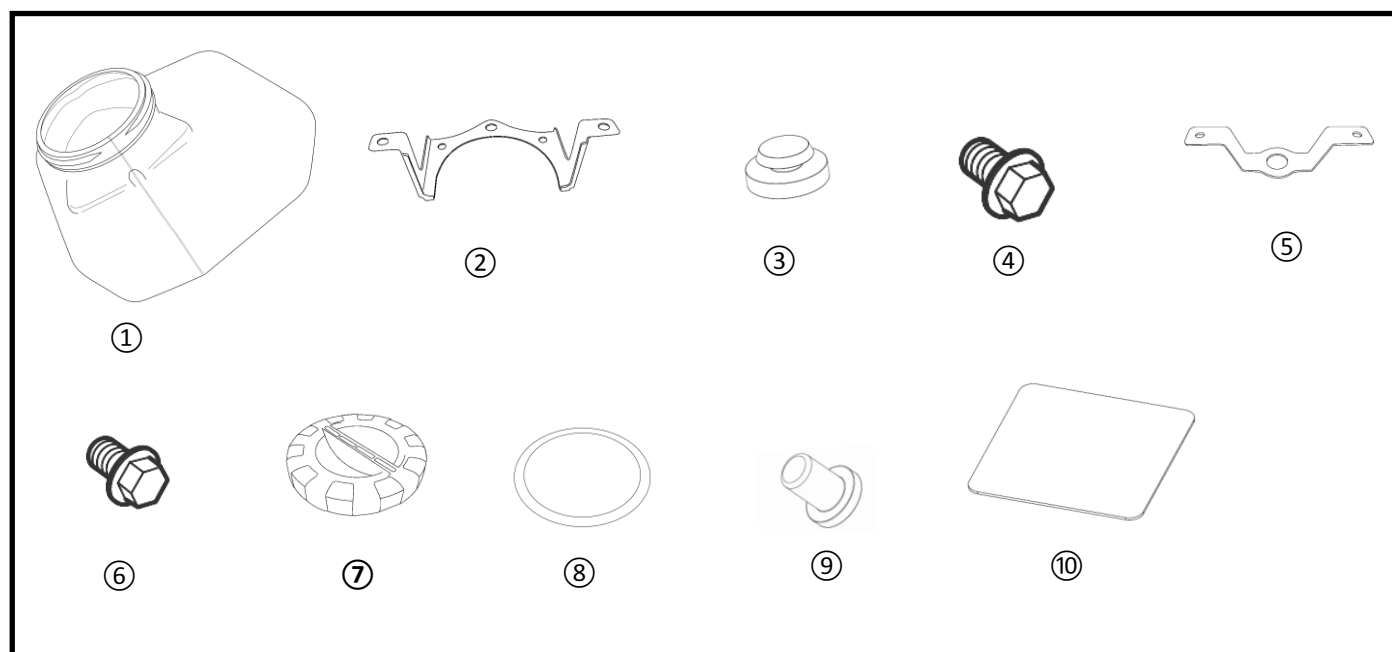

**Fig. 1**

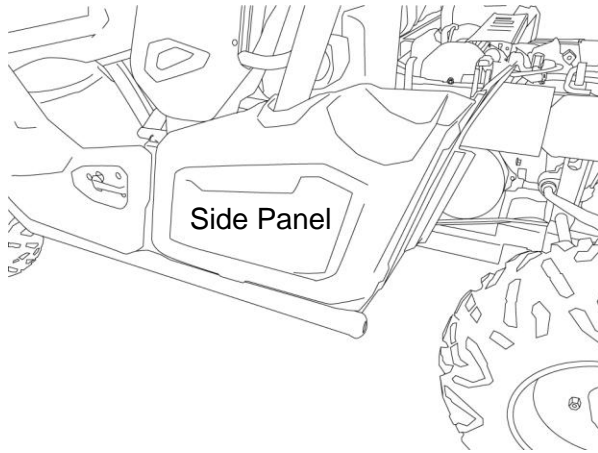

**Fig. 2**

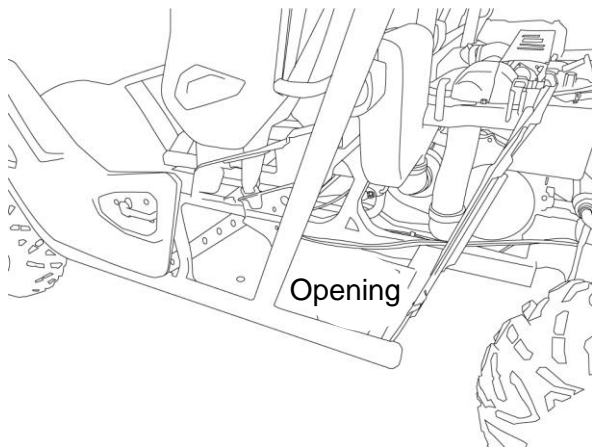

**Fig. 3**

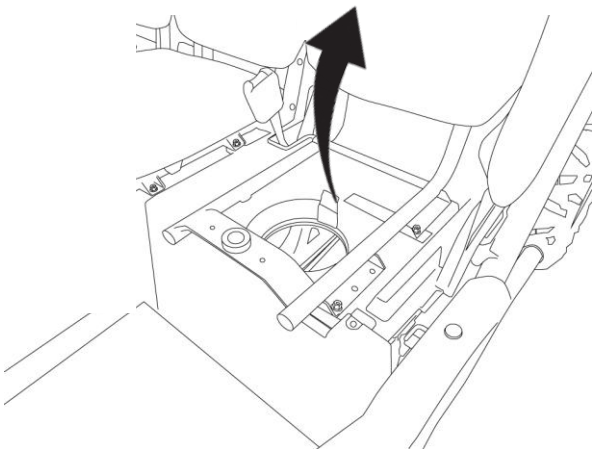

**PREPARATION:**

- Place vehicle on a secure and level surface.
- Set the parking brake.
- Clean all mounting surfaces before beginning installation.

**INSTALLATION:**

1. Remove backing and attach damper plate ⑩ to the bottom of the storage box ①.
2. Install seat pads ③ to the large storage box bracket ② as shown in (Fig. 6).
3. Remove the left hand side panel as shown in (Fig. 1).
4. Fit the storage box through the opening depicted in (Fig. 2).
5. Remove the driver seat base as shown in (Fig. 3).
6. Remove plastic rivets securing the under seat panel as shown in (Fig. 4) to gain access to the compartment where the storage box will be mounted as shown in (Fig. 5).
7. Use flange bolts ⑥ to install the small storage box bracket ⑤ referencing (Fig. 6). Torque flange bolts to 6 Nm (0.6 m • kg, 4.3 ft • lb).
8. Slide the storage box forward and place the finger located on the right hand side of the storage box into the hole in the middle of the small storage box bracket ⑤.
9. Mount the large storage box bracket ② using two flange bolts ④ referencing (Fig. 6) and torque them to 15 Nm (1.5 m • kg, 11 ft • lb). The storage box is not shown in this picture to show the storage box brackets mounting positions.
10. Install plug ⑨ by reaching into the storage box and pressing it to fit.
11. Remove backing and attach cap seal ⑧ to cap ⑦ and install the cap onto the storage box.
12. Assemble in reverse order.

**Fig. 4**

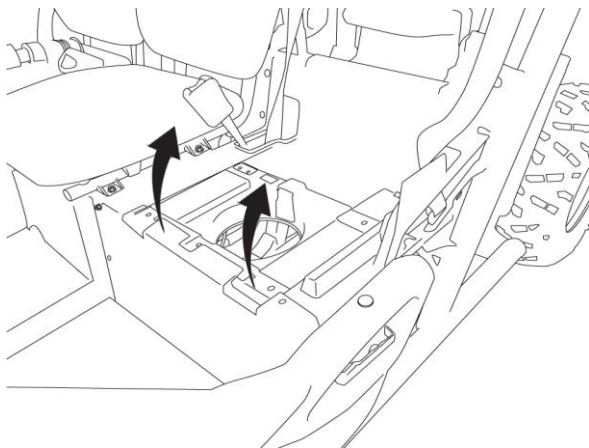

**MAINTENANCE:**

Periodically check all hardware for tightness and re-torque as required.

**CARE AND CLEANING:**

Wash using a mild soap and water solution and soft cloth.

**CUSTOMER SERVICE:**

For further information see your Yamaha dealer.

**ESTIMATED TIME TO INSTALL: 1.0 HRS**

**Fig. 5**

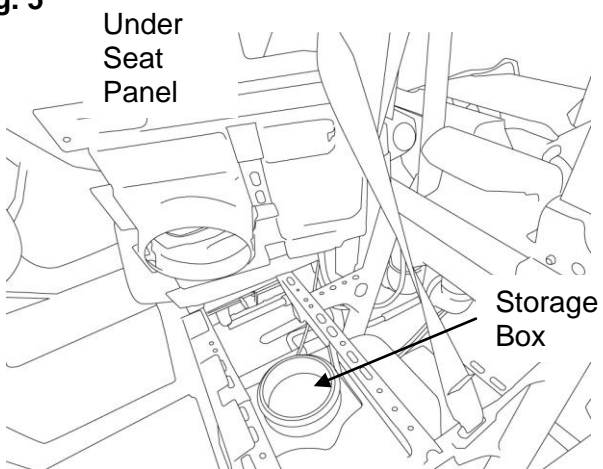

**Fig. 6**

